



SUBHA PRADA
builders and developers

We have chosen a location that gives you access to every convenience, while giving you an address you can be proud of. **White Stone** is located near elite surya city on Anekal Main Road. live in an oasis of tranquility yet be connected to the best amenities of Hosur Road like shopping, reputed schools, hospitals and restaurants in a short drive. Highways will take you to Bommasandra and Chandapura Circle in around 10 minutes drive. An apartment at **White Stone** surely guarantees joy for a lifetime.



YOU
Inspire
YOU
Upscale
YOUR
Pleasure
YOUR
Soul
YOUR
Decision

Project Promoted By :



SUBHA PRADA
builders and developers

Office Address : No. 640, MIG, Surya City Phase I
Anekal Road, Bengaluru - 560 001 Karnataka State
Mobile : +91 720 430 1235
7022595535

Architectural Consultants :



WHITESTONE

Home that
Inspires
you to do better

Disclaimer : The brochure is only a conceptual presentation of the project and not a legal offering. The promoters reserve the right to make changes in the elevation, plans and specifications as deemed fit.

www.subhaprada.com

www.subhaprada.com

 <https://www.facebook.com/subhapradabuilders>

 <https://www.facebook.com/subhapradabuilders>

Live in a home that spells luxury with comfortable, well-appointed, creatively designed apartments and spacious green outdoors, white stone rolls out as a symbol of luxury living near the upscale environment of bangalore. The luxury apartment incorporate intelligent space planning, desirable facilities to give distinct facilities for uncompromising customers like you who want to scale new heights in the coming future.

Swimming Pool | Gym | Senior Citizens & Family Sit Out Area
Landscaping Walking Track | Community Hall
24x7 Security System | Power Backup



Swimming Pool

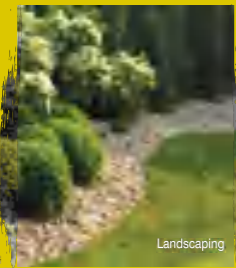

Landscaping

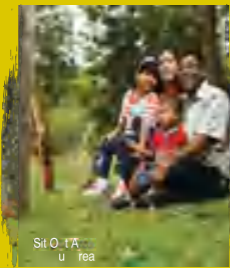

Sit Out Area



Gym

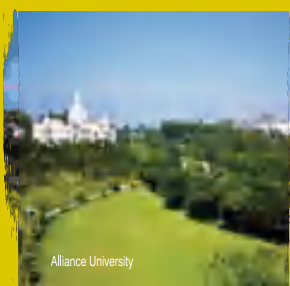

Alliance University



Hosur Road - Chandapura Flyover Railway Crossing

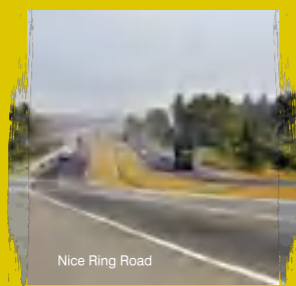

Nice Ring Road



Narayana Hrudayalaya

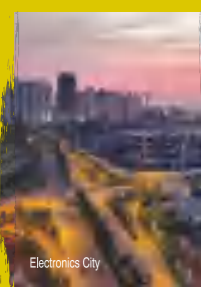

Electronics City



Metro Rail Service

Choose an
Upscale
environment

Park your car with
Pleasure



Flat No.4, 1290 sq. Ft.

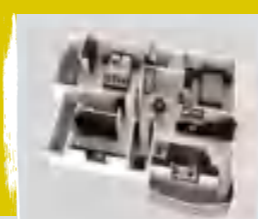

Flat No.2, 1290 sq. Ft.



Flat No.3, 1200 sq. Ft.



Flat No.1, 1200 sq. Ft.

Luxury for the
Soul



Making the right
Decision

At last, a home that truly gives you all the features you want, and allows you the luxury of enjoying them at your own comfort. **White Stone** is a Community of just 60 luxurious apartment set with 3 magnification towers, An address where the fine balance between the number of apartment and the facilities offered has been judiciously controlled. So you never have to wait for your turn to enjoy what is truly yours.

Our promise of giving you all spaces you want doesn't end with just your home, open space parts of which are tastefully landscaped, which means you can let both your mind and body wander around the wide expanses.

<p>Structure RCC framed structure with M-20 Grade concrete, Fe 500 Grade TMT steel.</p>	<p>Flooring 24" x 24" Polished vitrified tiles with 4" skirting of reputed brand for hall, dining, kitchen and bedrooms. 12" x 12" anti skid ceramic tiles flooring for balconies & utility.</p>	<p>Water Supply Adequate water supply through bore-wells.</p>
<p>Walls External walls with 6" solid concrete Blocks, internal walls with 4" solid concrete blocks.</p>	<p>Kitchen Kitchen platform with 40 mm granite top and stainless steel sink. Digital tiles dado up to 2' height above platform. Utility: Glazed ceramic tile dado upto 3' height.</p>	<p>Plumbing CPVC & PVC pipes of Supreme / Ashirwad flowguard plumbing system.</p>
<p>Water proofing Water proofing cement plaster over a coat of brush bonds for lift pits, toilets, water tanks & terrace.</p>	<p>Toilets Anti skid matching tile flooring with digital tiles dado up to 7" height. Parry ware / Hind ware or equivalent sanitary fittings. Jaquar or ESS ESE make or equivalent CP fittings.</p>	<p>Communication Individual telephone, Wi-Fi and TV points in living room.</p>
<p>Plastering External walls with sponge finish. Internal walls smoothly plastered with lime rendering. Iron Mesh work for the joints between brick work and RCC.</p>	<p>Electricals Concealed copper wiring of Anchor, Havell's or equivalent make and Anchor-Roma modular switches with metal box. Geyser & exhaust points in all toilets. AC points in master bedrooms. Mixer/grinder/oven/aqua guard points in kitchen.</p>	<p>Generator Power back-up generator for common areas, Lifts and for water pump.</p>
<p>Doors & Windows Teak wood door frame for main door, and designer moulded with antiquity fittings. All internal doors in Sal wood frames with powder coated aluminum fittings. Windows : UPVC powder coated or aluminum 3 track windows.</p>	<p>Painting Interior - Asian emulsion paints over birla wallcare putty for internal walls. Apex weather proof paints for exteriors. Textured / Cladding surfaces in selective places. Polish for main door, Asian enamel paints for internal doors and windows.</p>	<p>Common Areas Granite flooring for corridors and staircase. Granite cladding for the lift.</p> <p>Lift 4 passenger lift of ISI Standard for each tower.</p>